

EAST SUSSEX COUNTY COUNCIL
(EXCEAT BRIDGE REPLACEMENT – A259 EASTBOURNE ROAD)
BRIDGE SCHEME 2023

THE HIGHWAYS ACT 1980

The East Sussex County Council (“the Council”) makes this scheme in exercise of their powers under section 106(3) of the Highways Act 1980 and all other powers enabling them in that behalf:-

1. The Council are authorized to construct over the navigable waters of the Cuckmere River the bridge specified in the Schedule to this Scheme as part of the highway they are proposing to construct as a replacement for the Exceat Bridge carrying the A259 Eastbourne Road in the Parish of Cuckmere Valley & the Parish of Sutton with Seaford in the County of East Sussex.
2. This Scheme may be cited as The East Sussex County Council (Exceat Bridge Replacement – A259 Eastbourne Road) Bridge Scheme 2023.

The Common Seal of
EAST SUSSEX COUNTY COUNCIL
was hereunto affixed in the presence of:



A handwritten signature in black ink, consisting of a stylized 'A' and 'O' with a flourish, written over a dotted line.

Attesting Officer

1026649

on the 3rd day of October 2023

THE SCHEDULE

Plans and Specification The East Sussex County Council (Exceat Bridge Replacement – A259 Eastbourne Road) Bridge Scheme 2023

The location and general design of the Bridge are shown on plans numbered 3520000-CH2-SBR-SY2-0129-DR-CB-1001, 3520000-CH2-SBR-SY2-0129-DR-CB-1002, 3520000-CH2-SBR-SY2-0129-DR-CB-1003 and annexed hereto marked "The East Sussex County Council (Exceat Bridge Replacement – A259 Eastbourne Road) Bridge Scheme 2023"

POINTS OF COMMENCEMENT AND TERMINATION

Commencing from a point to the west of the Cuckmere River 22 metres north of the middle of the existing highway.

The bridge will pass in one span over the 26.3 metre wide Cuckmere River.

Terminating on the east side of the Cuckmere River at a point 17 metres to the north of the middle of the existing highway.

SPAN

A one span structure of 30.3 metres.

HEADWAY AND WATERWAY

The Headway shall not be less than 2.27 metres above normal water level of 3.37 metres Above Ordnance Datum. This Headway shall be maintained at 100 percent of the Cuckmere River width at normal water level.

OVERALL DIMENSIONS

The Bridge will be 19.105 metres wide overall and will carry a 6.5 metre wide single carriageway bordered either side by hard surfacing of 2.275 metres in width on the south side of the bridge and 1.83 metres width on the north side. The carriageway and hard surfacing will be bounded by 0.8 metre wide girders on the north and south side. The northern girder will be bounded by a 1.5 metre width to accommodate a footway along the northern length of the bridge. The southern girder will be bound by a 3 metre width to accommodate a footpath/cycleway along the southern length of the bridge. In addition, a 2 metre width is included on the southern side, beyond the footpath/cycleway, to accommodate a viewing platform over a 7 metre length. The bridge will be bounded by 1.2 metre high parapets on the north footpath and viewing platform and 1.5 metres high on the south footpath/cycleway.

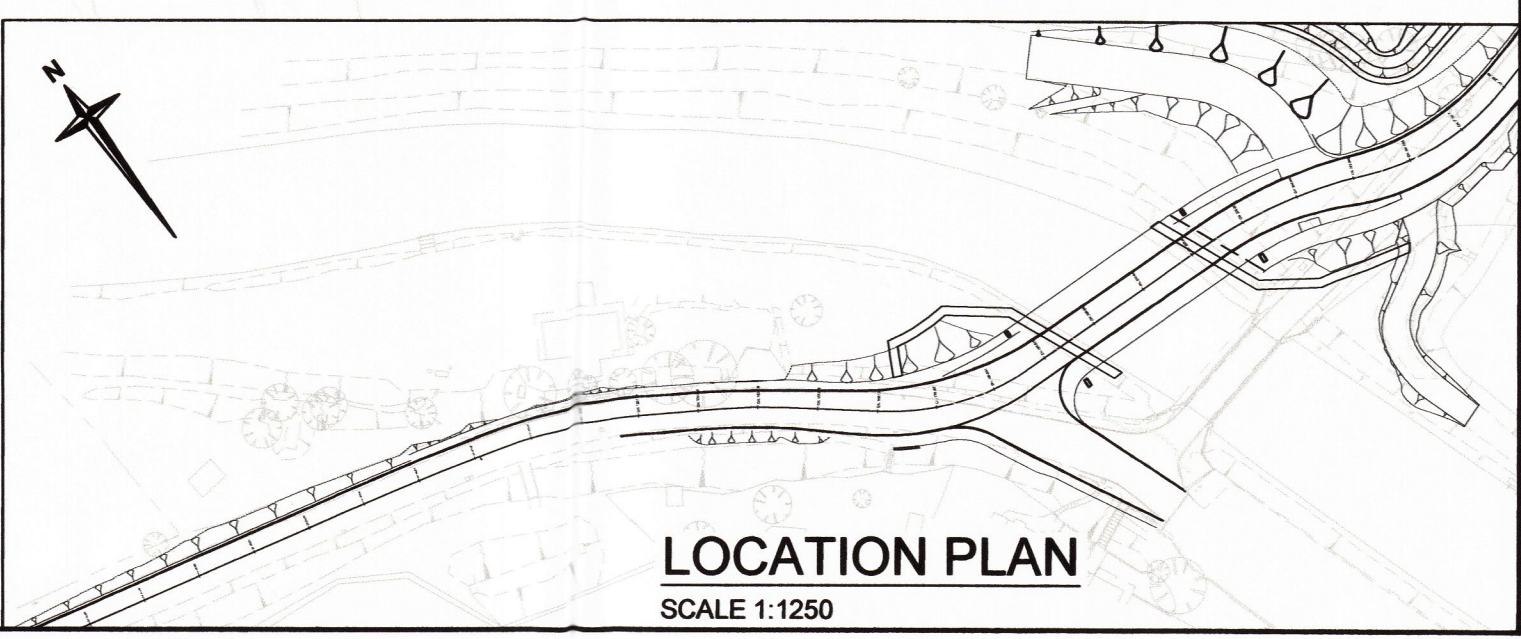
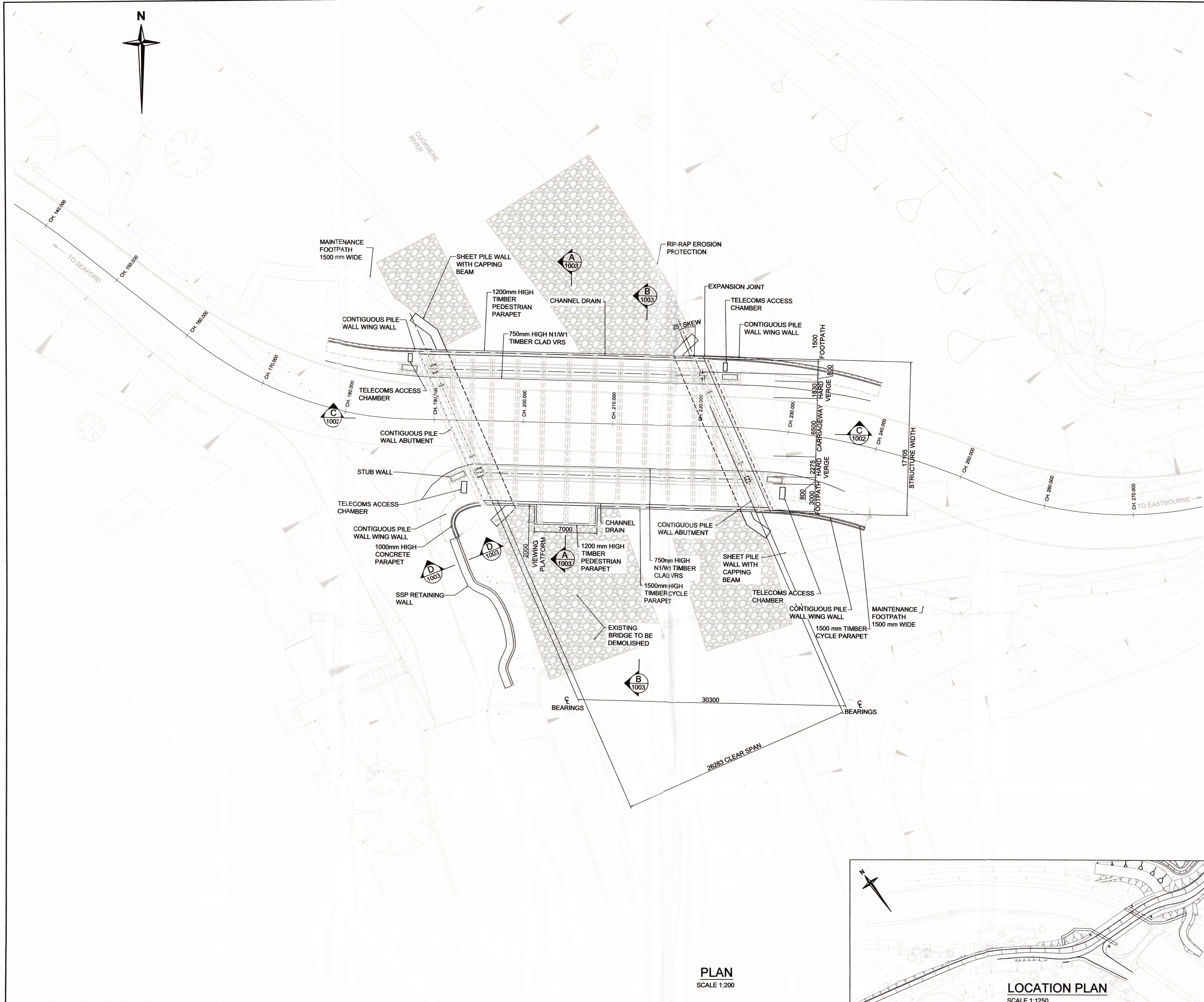

- Notes:
1. This drawing is to be read in conjunction with all other drawings in this series. Refer to Drawing No. 3520000-CH2-SBR-SY2-0129-DR-CB-1000 for drawing list and general notes
 2. All dimensions are in millimetres unless noted otherwise.
 3. All levels are in metres Above Ordnance Datum (AOD) unless noted otherwise.
 4. All chainages are in metres unless noted otherwise.
 5. Do not scale from this drawing.
 6. For rip-rap details, refer to drawings 3520000-CH2-SGN-SY2-0129-DR-CX-0001 and 0002
 7. For stub wall details refer to drawing 3520000-CH2-SBR-SY2-0129-DR-CB-2002 and 2003
 8. For highway's general arrangement refer to drawing 3520000-CH2-HGN-SY2-0129-DR-CH-0003

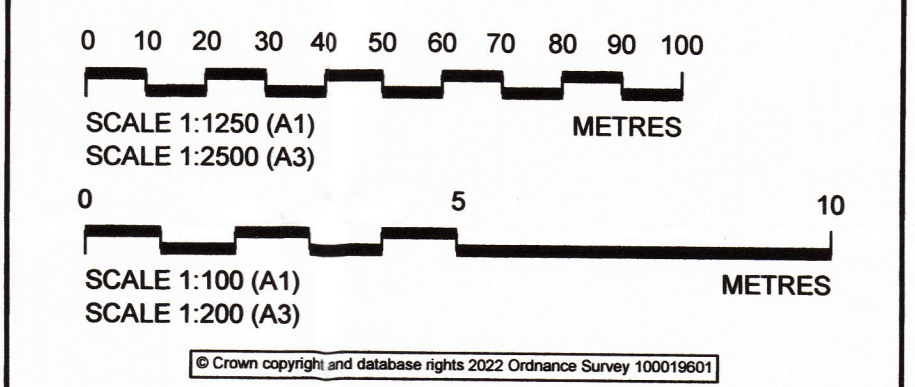

The Common Seal of
THE EAST SUSSEX COUNTY COUNCIL
was hereto affixed in the presence of:

Attesting Officer

on the _____ day of _____ 2023

East Sussex Highways
A partnership between:
Jacobs

EAST SUSSEX HIGHWAYS
RINGMER DEPOT, THE BROYLE
RINGMER, EAST SUSSEX, BN8 5NP
Tel. 0345 60 80 193 www.eastsussexhighways.com

Project

**EAST SUSSEX COUNTY COUNCIL
(EXCEAT BRIDGE REPLACEMENT -
A259 EASTBOURNE ROAD)
BRIDGE SCHEME 2023**

Drawing title

**EXCEAT BRIDGE ORDER
GENERAL ARRANGEMENT
SHEET 1 OF 3**

Drawing No. 3520000-CH2-SBR-SY2-0129-DR-CB-1001	Scale 1:200 @ A1	Rev P02
--	---------------------	------------

© Copyright 2023 Jacobs U.K. Limited. The concepts and information contained in this document are the property of Jacobs. Use or copying of this document in whole or in part without the written permission of Jacobs constitutes an infringement of copyright. This drawing has been prepared on behalf of, and for the exclusive use of, Jacobs' Client, and is subject to, and issued in accordance with, the provisions of the contract between Jacobs and the Client. Jacobs accepts no liability or responsibility whatsoever for, or in respect of, any use of, or reliance upon, this drawing by any third party.

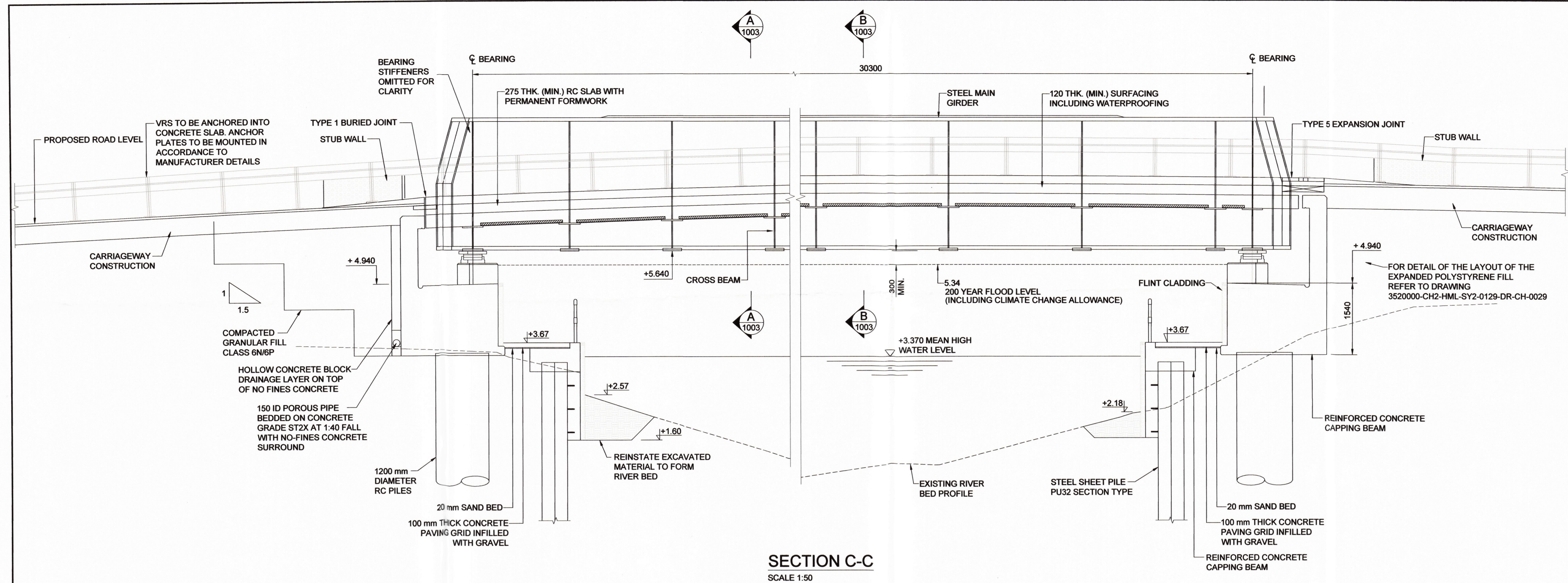

SECTION C-C
SCALE 1:50



SOUTH ELEVATION
NTS

- Notes:
1. This drawing is to be read in conjunction with all other drawings in this series. Refer to Drawing No. 3520000-CH2-SBR-SY2-0129-DR-CB-1000 for drawing list and general notes.
 2. All dimensions are in millimetres unless noted otherwise.
 3. All levels are in metres Above Ordnance Datum (AOD) unless noted otherwise.
 4. All chainages are in metres unless noted otherwise.
 5. Do not scale from this drawing.
 6. All exposed faces of wingwalls and abutments to be flint stone clad.

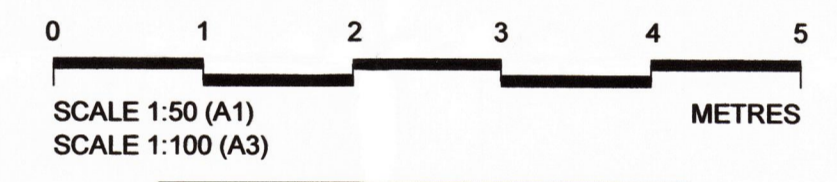

The Common Seal of THE EAST SUSSEX COUNTY COUNCIL was hereunto affixed in the presence of:

Attesting Officer

on the _____ day of _____ 2023

East Sussex Highways
A partnership between:

EAST SUSSEX HIGHWAYS
RINGMER DEPOT, THE BROYLE
RINGMER, EAST SUSSEX, BN8 5NP
Tel. 0345 60 80 193 www.eastsussexhighways.com

Project

EAST SUSSEX COUNTY COUNCIL
(EXCEAT BRIDGE REPLACEMENT -
A259 EASTBOURNE ROAD)
BRIDGE SCHEME 2023

Drawing title

EXCEAT BRIDGE ORDER
GENERAL ARRANGEMENT
SHEET 2 OF 3

Drawing No. 3520000-CH2-SBR-SY2-0129-DR-CB-1002 Scale 1:50 @ A1 Rev P02

© Copyright 2023 Jacobs U.K. Limited. The concepts and information contained in this document are the property of Jacobs. Use or copying of this document in whole or in part without the written permission of Jacobs constitutes an infringement of copyright. Limitation: This drawing has been prepared on behalf of, and for the exclusive use of Jacobs' Client, and is subject to, and issued in accordance with, the provisions of the contract between Jacobs and the Client. Jacobs accepts no liability or responsibility whatsoever for, or in respect of, any use of, or reliance upon, this drawing by any third party.

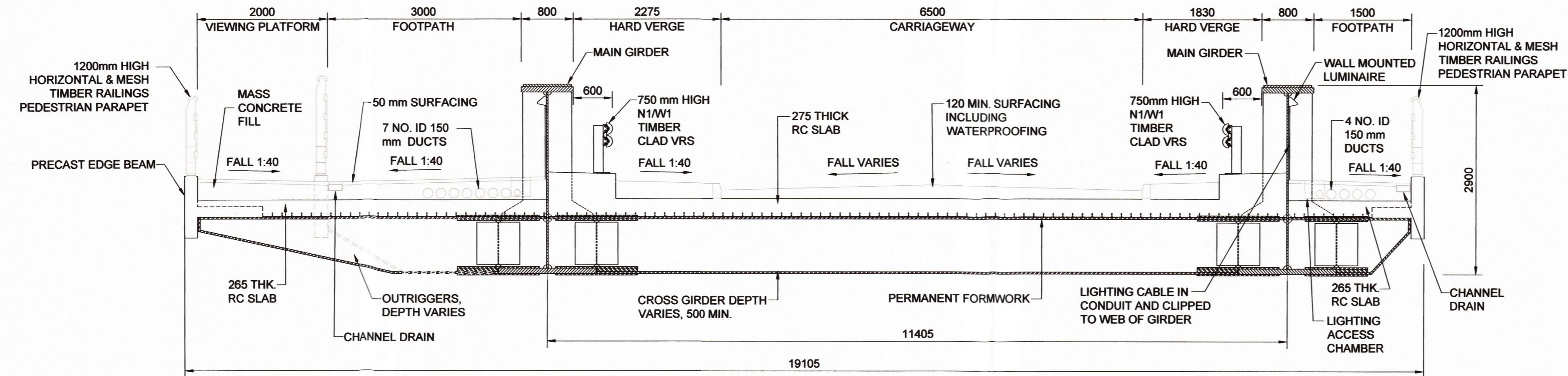

SECTION A-A
SCALE 1:50

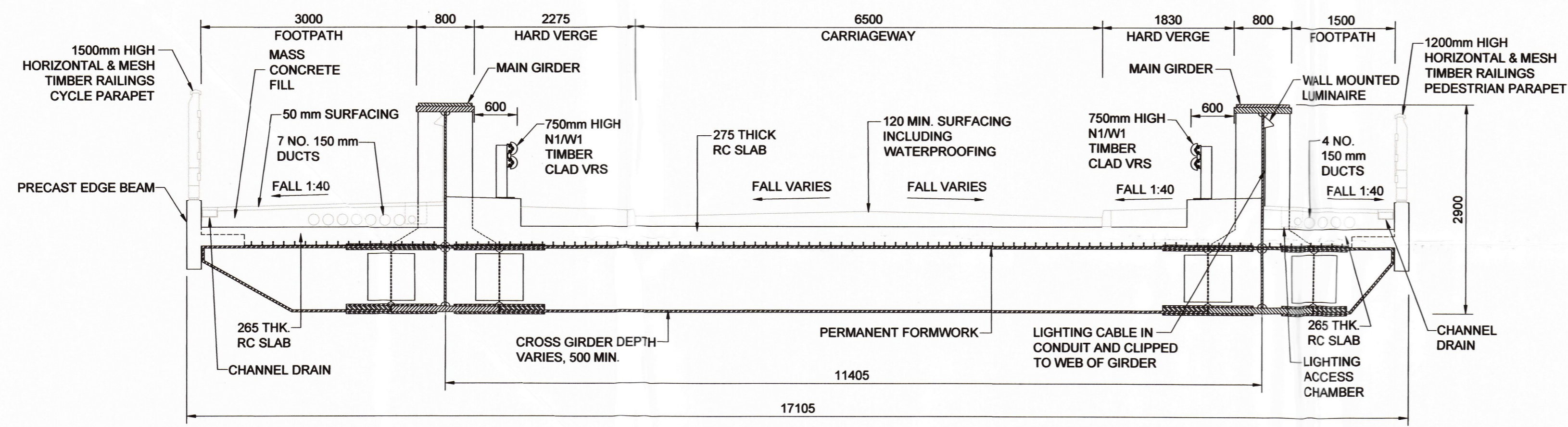

SECTION B-B
SCALE 1:50

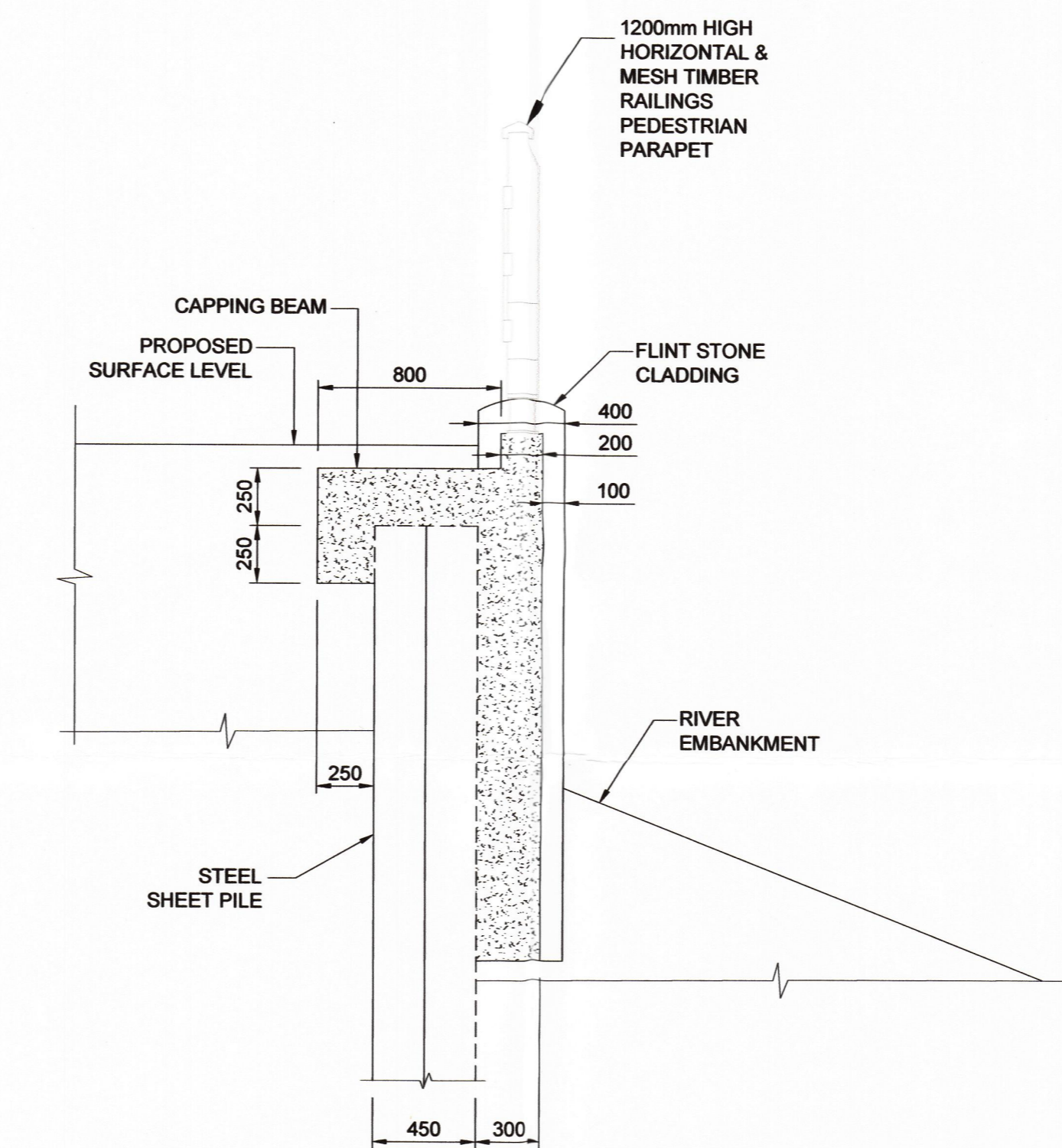

SECTION D-D
SCALE 1:25

- Notes:
1. This drawing is to be read in conjunction with all other drawings in this series. Refer to Drawing No. 3520000-CH2-SBR-SY2-0129-DR-CB-1000 for drawing list and general notes
 2. All dimensions are in millimetres unless noted otherwise.
 3. All levels are in metres Above Ordnance Datum (AOD) unless noted otherwise.
 4. All chainages are in metres unless noted otherwise.
 5. Do not scale from this drawing.
 6. Same waterproofing system to be applied across the whole deck, including footpaths.

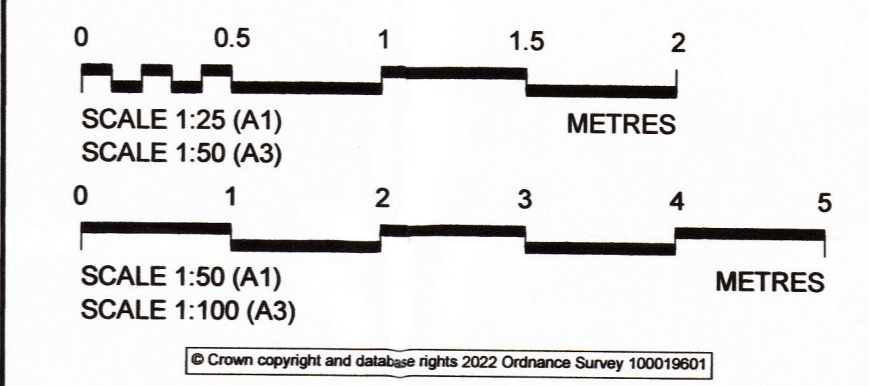

The Common Seal of
THE EAST SUSSEX COUNTY COUNCIL
was hereunto affixed in the presence of:

Attesting Officer

on the _____ day of _____ 2023

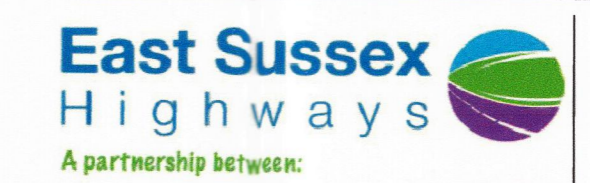

EAST SUSSEX HIGHWAYS
RINGMER DEPOT, THE BROYLE
RINGMER, EAST SUSSEX, BN8 5NP
Tel. 0345 60 80 193 www.eastsussexhighways.com

Project

**EAST SUSSEX COUNTY COUNCIL
(EXCEAT BRIDGE REPLACEMENT -
A259 EASTBOURNE ROAD)
BRIDGE SCHEME 2023**

Drawing title

**EXCEAT BRIDGE ORDER
GENERAL ARRANGEMENT
SHEET 3 OF 3**

Drawing No. 3520000-CH2-SBR-SY2-0129-DR-CB-1003 Scale 1:200 @ A1 Rev P02

© Copyright 2023 Jacobs U.K. Limited. The concepts and information contained in this document are the property of Jacobs. Use or copying of this document in whole or in part without the written permission of Jacobs constitutes an infringement of copyright. Limitation: This drawing has been prepared in partial of, and for the exclusive use of Jacobs' Client, and is subject to, and issued in accordance with, the provisions of the contract between Jacobs and the Client. Jacobs accepts no liability or responsibility whatsoever for, or in respect of, any use of or reliance upon, this drawing by any third party.