

Dated 3rd October 2023

Highways Act 1980

**EAST SUSSEX COUNTY COUNCIL
(EXCEAT BRIDGE REPLACEMENT- A259 EASTBOURNE ROAD)
(CLASSIFIED ROAD)
(SIDE ROADS) ORDER 2023**

Governance Services Department
East Sussex County Council
County Hall
Lewes
East Sussex
BN7 1UE

THE HIGHWAYS ACT 1980

EAST SUSSEX COUNTY COUNCIL

(EXCEAT BRIDGE REPLACEMENT – A259 EASTBOURNE ROAD)

(CLASSIFIED ROAD) (SIDE ROADS) ORDER 2023

The East Sussex County Council (“the Council”) makes this order in exercise of powers conferred by Sections 14 and 125 of the Highways Act 1980 (“the 1980 Act”) and all other powers enabling them in that behalf: -

1. (1) The Council is authorised, in relation to the classified road in the Parish of Cuckmere Valley & the Parish of Sutton with Seaford in the County of East Sussex to:
 - (a) stop up each length of highway described in the Schedules and shown on the corresponding Site Plan by zebra hatching;
 - (b) construct a new highway along each route whose centre line is shown on a Site Plan by an unbroken black line surrounded by stipple;
 - (c) stop up the private means of access to premises described in the Schedules and shown on the corresponding Site Plan by a solid black band; and
 - (d) provide new means of access to premises at each location shown on the Site Plan by thin diagonal hatching;
 - (2) Where a new highway is to be constructed wholly or partly along the same route as a new access or part of one, that new highway shall be created subject to the private rights over that new access.
 - (3) Each new highway is given a reference letter on a Site Plan, which is also placed in the respective Schedule, and will be a road unless the word “footpath”, “cycle track” or “bridleway” appears beneath its reference letter in that Schedule, in which case it will be a footpath, cycle track or bridleway (as the case may be). Each new access is given a number on a Site Plan, which is also placed in the respective Schedule.
 - (4) Where a new highway is to be constructed or a new access is to be provided in connection with the stopping up of a length of highway or private means of access described in the Schedule, its reference letter or number (as the case may be) is placed in the said Schedule opposite the description of that length.
 - (5) Each Site Plan shows the works indicated in the respective Schedule and has the same number as that Schedule, and the route of the classified road in relation to the works.
2. Where immediately before a length of highway is stopped up in pursuance of this Order there is under, in, on, over, along or across that highway any apparatus of statutory undertakers or any telecommunications code system operator, then, subject to section 21 of the Highways Act 1980, those undertakers, or that operator, as the case may be, shall have the same rights as respects that apparatus as they had immediately before the stopping up took place

3. The Council is satisfied –
- a) as respects each length of highway the stopping up of which is authorised by this Order, that another reasonably convenient route is available or will be provided before that length is stopped up, and
 - b) as respects each length of private means of access the stopping up of which is authorised by this Order, that other reasonably convenient means of access to the relevant premises are available or will be provided before that length is stopped up.

4. In this Order: -

- (a) distances are measured along the route of the relevant highway or private means of access to premises, as the case may be.
- (b) a reference to a Schedule or Site Plan number is a reference to the Schedule, or to the Site Plan, so numbered.

“the classified road” - means the

A259 Eastbourne Road;

- highway which the Council propose to construct a replacement bridge to carry the A259 Eastbourne Road over the Cuckmere River 22 metres north of the existing Exceat Bridge. The works will include realignment of the A259 Eastbourne Road to tie into the new bridge location and associated amendments to private means of access and public rights of way, which has been classified by the Secretary of State for Transport as a principal road for the purpose of the enactments and instruments which refer to roads classified as principal road in accordance with Section 12 of the Highways Act 1980;

“the Council” - means the East Sussex County Council;

“new access” - means a means of access to premises authorised by this Order to be provided;

“new highway” - means a highway authorised by this Order to be constructed and “new highways” shall be construed accordingly;

“Schedule” - means a Schedule to this Order, and Schedules” shall be construed accordingly;

“Site Plan” - means the plan marked Site Plan contained in the Plan Folio marked “EAST SUSSEX COUNTY COUNCIL (EXCEAT BRIDGE REPLACEMENT – A259 EASTBOURNE ROAD) (CLASSIFIED ROAD) (SIDE ROADS) ORDER 2023” sealed with the Common Seal of the Council and deposited at:

East Sussex County Council, County Hall, St Anne’s Crescent, Lewes, East Sussex, BN7 1UE.

Seaford Library, 15-17 Sutton Park Rd, Seaford, BN25 1QX.

Eastbourne Library, Grove Rd, Eastbourne, BN21 4TL

a duplicate has been deposited in the offices of the Secretary of State for Transport.

SCHEDULE

Locality: Parish of Cuckmere Valley & Parish of Sutton with Seaford.

SITE PLAN

HIGHWAY (S) TO BE IMPROVED

None

HIGHWAY (S) TO BE STOPPED UP

REFERENCE LETTER (S) OF NEW HIGHWAYS (S)

Part of footpath CMV/15/7 to be stopped up from its junction with the A259 Eastbourne Road in a north westerly direction for 62 metres and labelled 1/S1 on the Site Plan.	1/A Footpath
Part of classified road known as A259 Eastbourne Road to be stopped up from a point 28 metres east of the property known as The Cuckmere Inn in an easterly direction for 25 metres and labelled 1/S2 on the Site Plan.	-
Part of footpath CMV/24/1 to be stopped up from its junction with the A259 Eastbourne Road in a southerly direction for 17 metres and labelled 1/S3 on the Site Plan.	1/B Footpath

PRIVATE MEANS OF ACCESS TO BE STOPPED UP

REFERENCE NUMBER (S) OF NEW ACCESSES

Part of the stepped private means of access to be stopped up serving Blackberry Cottage from its junction with the A259 Eastbourne Road in a south westerly direction for 3 metre and labelled 1/1 on the Site Plan.	1/1a
Part of the stepped private means of access to be stopped up serving The Cuckmere Inn from its junction with the A259 Eastbourne Road in a westerly direction for 1 metre and labelled 1/2 on the Site Plan.	1/2a
Part of private means of access to be stopped up from its junction with the A259 Eastbourne Road in a northerly direction for 1 metre and labelled 1/3 on the Site Plan.	1/3a
Part of private means of access to be stopped up from its junction with the A259 Eastbourne Road in a southerly direction for 37 metres and labelled 1/4 on the Site Plan.	1/3b

The Common Seal of
EAST SUSSEX COUNTY COUNCIL
was hereunto affixed in the presence of:



1026648

Attesting Officer

on the 3 day of October 2023

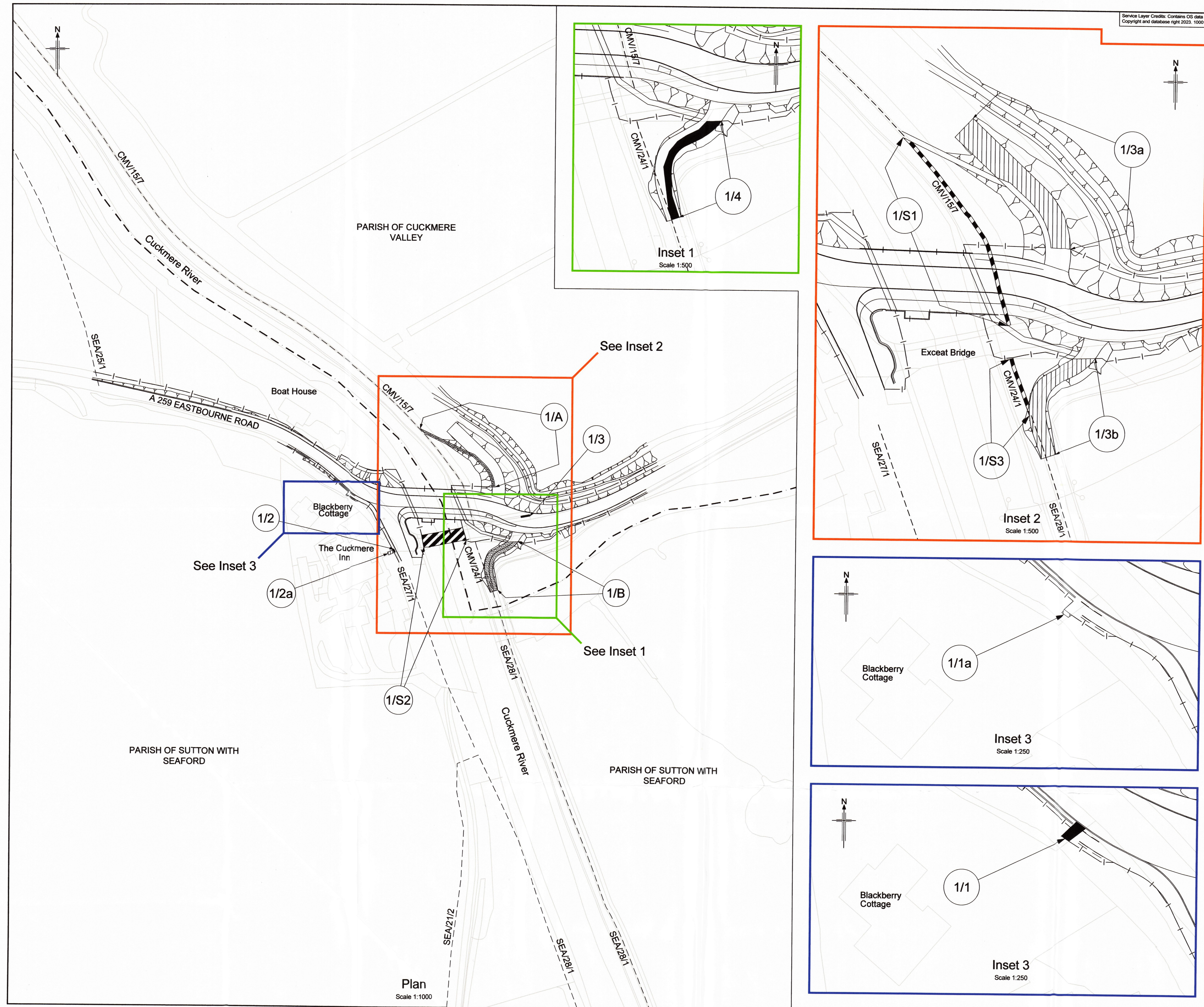

Service Layer Credits: Contains OS data © Crown Copyright and database right 2023, 100019001.

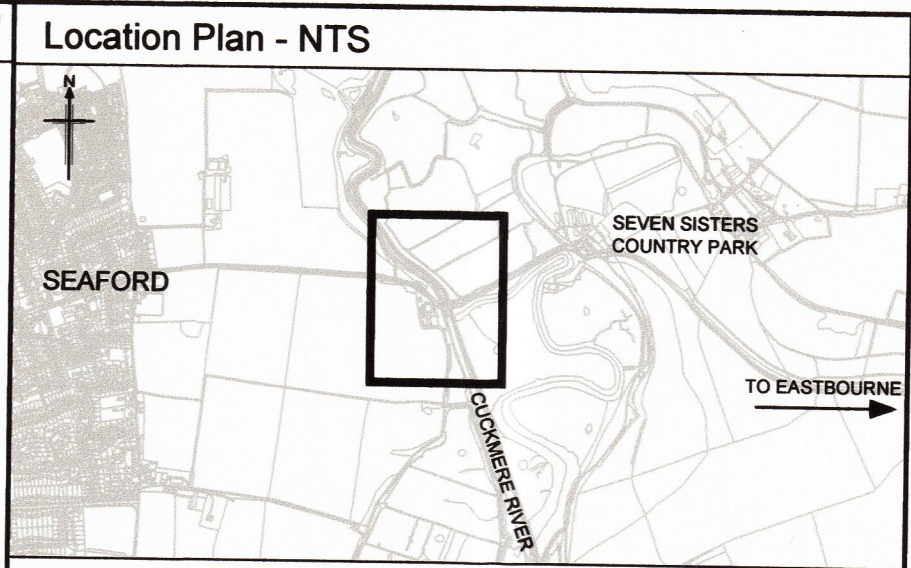

- KEY**
- Existing highway layout where it is proposed to be altered
 - Classified Road
 - Highway to be stopped up
 - Highway to be improved
 - New Highway
 - Private means of access to be stopped up
 - New means of access
 - Public Right of Way (PRoW)
 - Parish Boundary
 - Highway to be Stopped up
 - New Highway
 - Private Means of Access to be Stopped up
 - New Private Means of Access

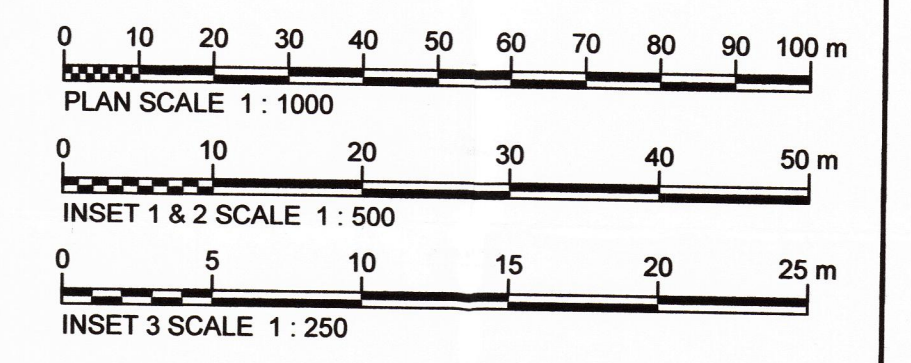

The Common Seal for EAST SUSSEX COUNTY COUNCIL was hereto affixed in the presence of

Attesting Officer

On the _____ Day of _____ 2023

Drawing No. B237385B-SRO-001 Revision P01

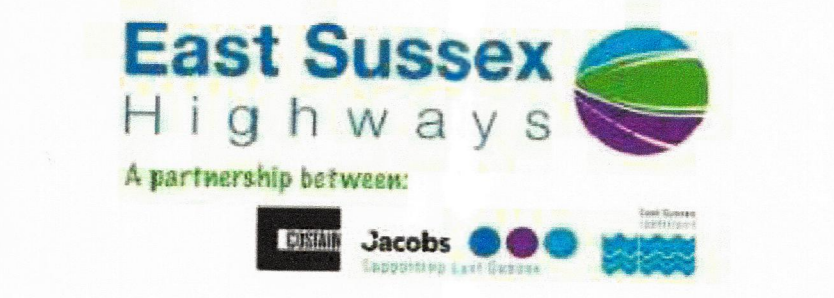

Project

**EAST SUSSEX COUNTY COUNCIL
 (EXCEAT BRIDGE REPLACEMENT -
 A259 EASTBOURNE ROAD)
 (CLASSIFIED ROAD)
 (SIDE ROADS) ORDER 2023**

Drawing title

**SIDE ROADS ORDERS
 SITE PLAN**

Drawing No. B237385B-SRO-001 Scale As shown @A1 Rev. P01

© Copyright 2023 Jacobs U.K. Limited. The concepts and information contained in this document are the property of Jacobs. Use or copying of this document in whole or in part without the written permission of Jacobs constitutes an infringement of copyright. This drawing has been prepared on behalf of, and for the exclusive use of, Jacobs' Client, and is subject to, and issued in accordance with, the provisions of the contract between Jacobs and the Client. Jacobs accepts no liability or responsibility whatsoever for, or in respect of, any use of, or reliance upon, this drawing by any third party.

